



GROWING A HEALTHY FUTURE

FOOD • FUEL • WATER • LANDSCAPES • PEOPLE

ALL HANDS

January 29, 2014

Nebraska East Union

Roadmap for Today's Conversation



- **Fiscal outlook / factors to watch**
- **Quick check on UNL strategic goals timelines and progress**
- **Welcoming new faculty!**

Roadmap for Today's Conversation



- **Optimizing resources and structure**
- **Honoring servant leadership of faculty and staff**
- **Infrastructure growth plans / progress**



Paying Attention to the Outside World

Annual Net Farm Income In Nebraska: 2001-2012

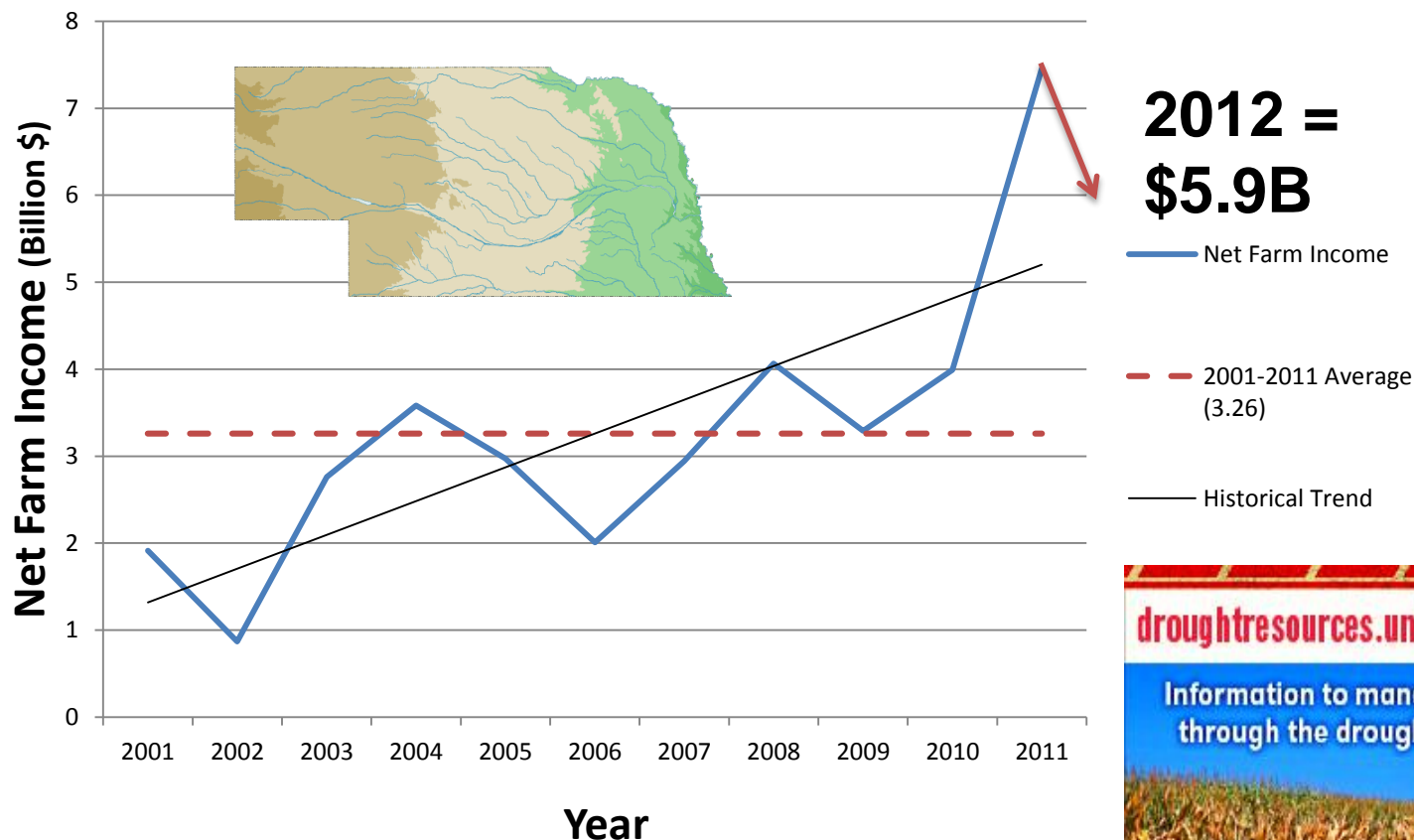

Source:ERS/USD

AG Economy Has Been in an Unprecedented Time – But Now Slowing

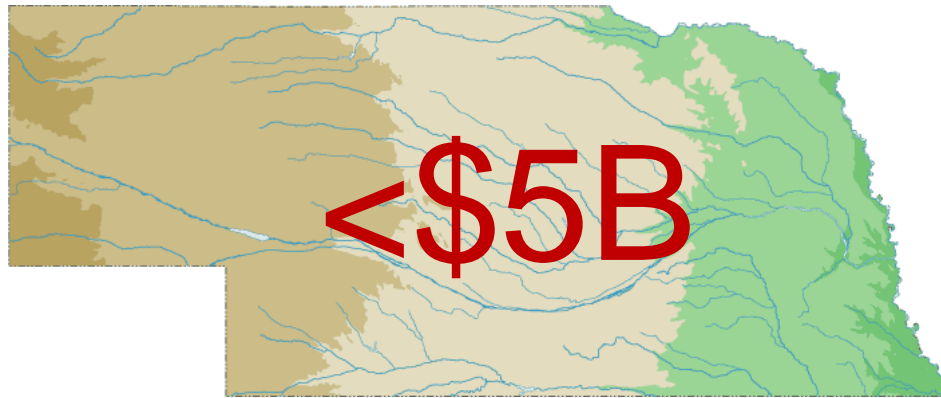

- Renewable fuel standards?
- Livestock expansion?
- “Anti-science” regulation?

2013 Farm Real Estate Value by State

Dollars per Acre and Percent Change from 2012

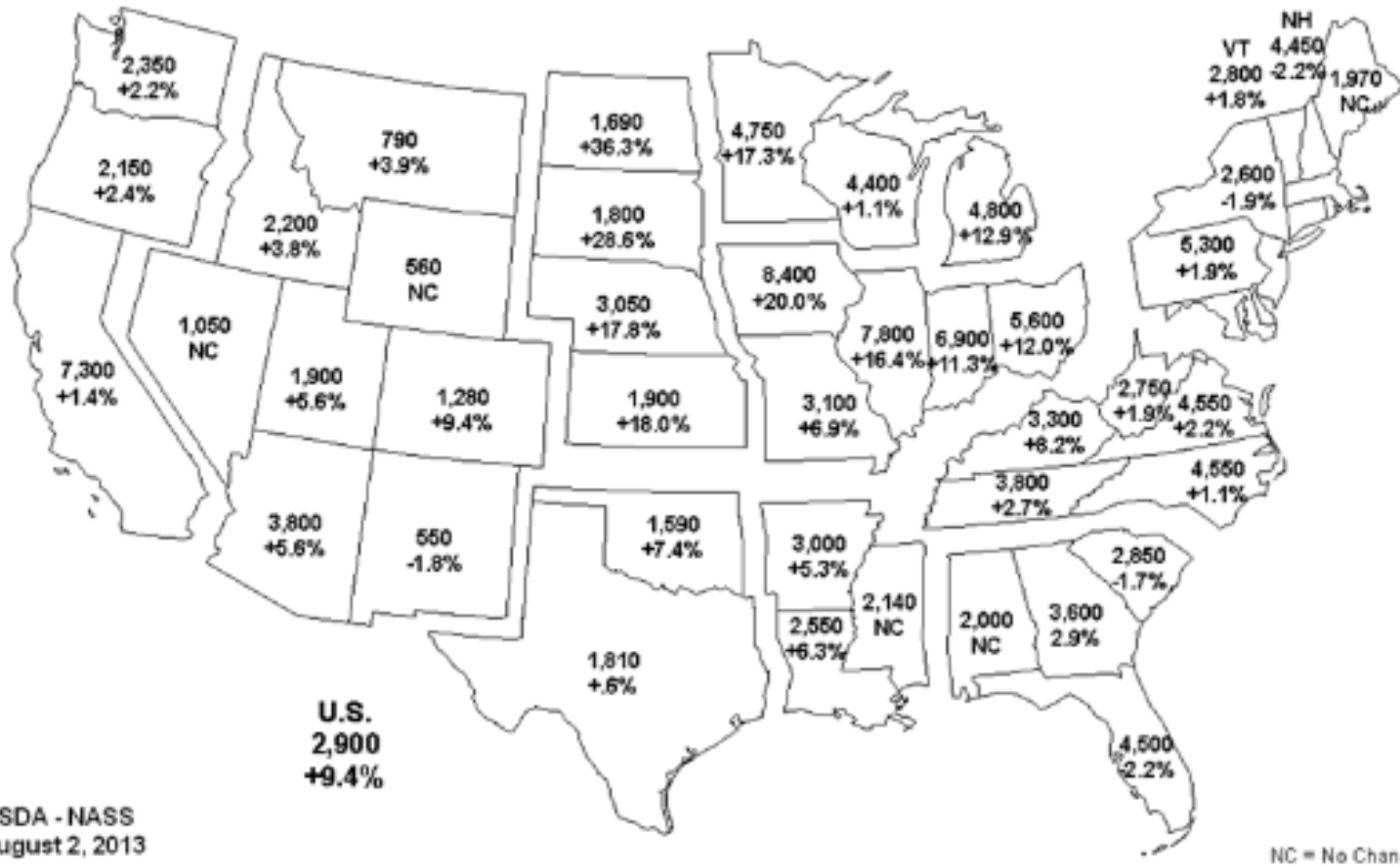

USDA - NASS
August 2, 2013





✓ **NIDIS**
authorizing
language in
Commerce
bill

- ✓ **NDMC**
authorizing
language
- ✓ **Animal**
research
authorizing
language



Paying Attention to the World



State Funding



- UNL is ~20% state funded, one of highest in APLU (IANR is 46%)
- Biennium budget for FY 14/15
 - Tuition affordability compact passed with ~4% per annum increases in NU budget
 - \$2.5M per year in POE funding (was \$1M)
 - Approximate 3% salary increase per year

State Funding



- Net effect – modest budget re-allocation to make permanent in FY 14
- Unicameral now in short session through April
 - Water funding request for \$50M
 - Tax reform proposals
 - Climate assessment response
 - Transfer credits amongst state institutions
 - Public information laws on university searches



State Funding



- Budget preparation year for FY 16/17 now underway
 - Engineering, infrastructure, PoE, NCTA
- Uncertainty surrounding state leadership – new executive and legislative team in 2015 session

PUBLISHED THURSDAY, JANUARY 16, 2014 AT 1:00 AM / UPDATED AT 12:30 PM



JAMES R. BURNETT/THE WORLD-HERALD

NU system enrollment grew to a near-record 50,705 under J.B. Milliken's nearly 10-year tenure as university president.

Leaving NU: J.B. Milliken praised as he looks toward future with CUNY system

By [Kate Howard Perry](#) / World-Herald staff writer

Federal Capacity Funding





GROWING A HEALTHY FUTURE

FOOD • FUEL • WATER • LANDSCAPES • PEOPLE

Program	FY 2012	FY 2013	FY 2014
Smith-Lever	294.0	271.6	300.0
Hatch	236.3	218.4	243.7
McIntire-Stennis	32.9	30.4	34.0
AFRI	264.5	277.0	316.4



GROWING A HEALTHY FUTURE

FOOD • FUEL • WATER • LANDSCAPES • PEOPLE

- **PCAST**
- **AGree**
- **Chicago Council on Global Affairs**
- **Council on Competitiveness**
- **SOAR (Supporters of Ag Research)**



WORKING TO MEET THE WORLD'S GROWING FOOD NEEDS

HEUERMANN LECTURES

2013

2014





REPORT TO THE PRESIDENT ON
AGRICULTURAL PREPAREDNESS
AND
THE AGRICULTURE
RESEARCH ENTERPRISE

Executive Office of the President
President's Council of Advisors on
Science and Technology

DECEMBER 2012



SCIENCE, TECHNOLOGY *and* INNOVATION

Whether it's improving our health or harnessing clean energy, protecting our security or succeeding in the global economy, our future depends on reaffirming America's role as the world's engine of scientific discovery and technological innovation.

- President Barack Obama



- Increase AFRI from \$265 to **\$500 M**
- Increase NSF basic funding for food and ag from \$120 to **\$250 M**
- **\$180 M** in USDA fellowship funding for graduate students and postdocs
- **Create six innovation clusters at \$150 M per year focused on emerging challenges in ag and food**
- Create a permanent scientific advisory committee to advise the USDA Chief Scientist



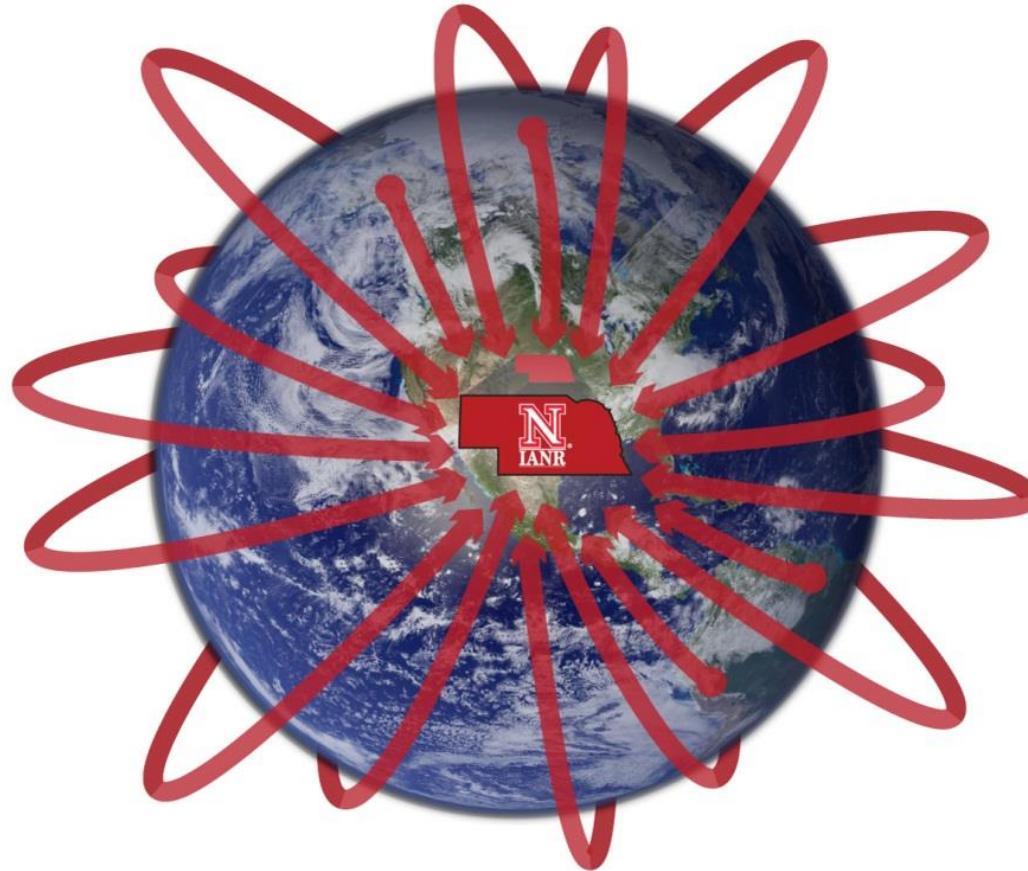

GROWING A HEALTHY FUTURE

FOOD • FUEL • WATER • LANDSCAPES • PEOPLE



Goals



- Increase Enrollment to 30,000
- Increase Faculty by ~170
- Increase 6-yr graduation rate to 70%
- Increase research expenditures to \$300 M
- Increase national/international recognition of faculty
- Successfully launch phase I of Nebraska Innovation Campus



Progress on 2018 Goals

- 1) 9th consecutive year of enrollment growth in Ag & Nat Res (**3.9 and 5.9%** increase leading UNL)
Fall 2014 admits up **24%**
- 2) First 6 months of FY14 on track to exceed 2012 record year for external funding (**\$41.2M** vs \$37.4M)
- 3) 6-year graduation rate of **~78%**
- 4) Increasing tenure-track faculty by ~13% (**46 FTE**) with additional 20 planned in phase II.
- 5) Leading the population and development of phase I of Nebraska Innovation Campus

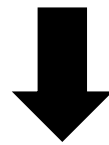

2018

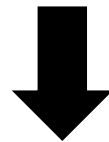

2025

Private Giving to the University is at an All-Time High . . .



> \$1.5 B



~ \$108 M

\$250 M



“25 by 2025”

Endowed Chair Campaign







CAMPAIGN for
NEBRASKA
UNIVERSITY of NEBRASKA FOUNDATION

- 1) Funding for Veterinary Diagnostic Lab
- 2) Funding for **Nebraska Innovation Campus** Phase I implementation.
- 3) Funding for major infrastructure investments on **UNL east campus**.
- 4) Funding for growth in Nebraska-wide research and extension campus.
- 5) Funding for **25 Presidential Chairs** in priority areas – currently 4 with 2 pending



 **GROWING A HEALTHY FUTURE**

FOOD • FUEL • WATER • LANDSCAPES • PEOPLE

IANR to 2025

Faculty Growth Initiative Phase I

Priority Positions – Status

- **36 Positions – hired 2 for two positions (therefore total of 38)**
 - **31 hires complete**
 - **4 searches ongoing**
 - **3 on hold**



Community Leadership Development

Lindsay Hastings



Assistant Professor
Agricultural Leadership, Education, &
Communication
Director of Nebraska Human Resources Institute

EDUCATION: Ph.D., University of Nebraska-Lincoln

START DATE: July 1, 2013



Advanced Machinery Systems Engineer

Santosh Pitla

Assistant Professor
Biological Systems Engineering

EDUCATION: Ph.D., University of Kentucky

START DATE: October 1, 2013

Rangeland Ecologist

Dirac Twidwell

Assistant Professor
Agronomy & Horticulture

EDUCATION: Ph.D., Texas A&M University

START DATE: November 4, 2013



Behavioral Economist

Simanti Banerjee

Assistant Professor
Agricultural Economics

EDUCATION: Ph.D., Pennsylvania State University

START DATE: August 1, 2014





Micrometeorologist

Andy Suyker

Associate Professor
School of Natural Resources

EDUCATION: Ph.D., University of Nebraska-Lincoln

START DATE: July 1, 2013



Cropping Systems Agronomist

Patricio Grassini

Assistant Professor
Agronomy & Horticulture

EDUCATION: Ph.D., University of Nebraska-Lincoln

START DATE: November 15, 2013

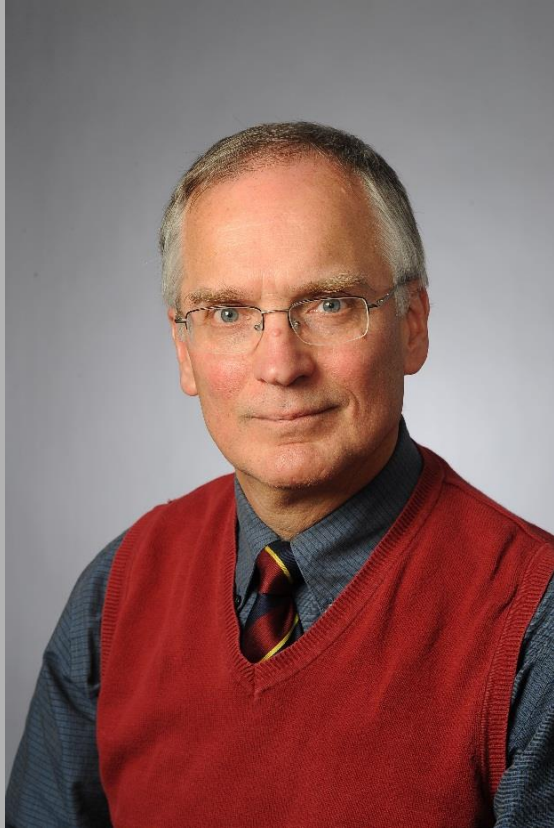

Cropping Systems Agronomist

Roger Elmore

Professor
Agronomy & Horticulture

EDUCATION: Ph.D., University of Illinois

START DATE: January 13, 2014



Life Sciences Education

Joe Dauer

Assistant Professor
School of Natural Resources

EDUCATION: Ph.D., Pennsylvania State University

START DATE: August 15, 2013

Science Literacy Coordinator

Cory Forbes

Associate Professor
School of Natural Resources

EDUCATION: Ph.D., University of Michigan

START DATE: January 2, 2014





Science Literacy Specialist

Jenny Melander

Assistant Professor
Biological Systems Engineering

EDUCATION: Ph.D., University of Missouri-Kansas City

START DATE: August 1, 2013

Plant Arthropod Interactions

Joe Louis

Assistant Professor
Entomology & Biochemistry

EDUCATION: Ph.D., University of North Texas

START DATE: October 7, 2013



Plant Molecular Physiologist

Rebecca Roston

Assistant Professor
Biochemistry

EDUCATION: Ph.D., University of California-Davis

START DATE: July 1, 2014





Plant Molecular Physiologist

Daniel Schachtman

Professor
Agronomy & Horticulture

EDUCATION: Ph.D., The Australian National
University

START DATE: February 3, 2014

Advanced Sensing Systems Engineer

Yufeng Ge

Assistant Professor
Biological Systems Engineering

EDUCATION: Ph.D., Texas A&M University

START DATE: January 1, 2014

.





Plant Biotic Stress Biologist

Lirong Zeng

Assistant Professor
Plant Pathology

EDUCATION: Ph.D., Ohio State University

START DATE: July 1, 2014



Plant Virologist

Hernan Garcia-Ruiz

Assistant Professor
Plant Pathology & Nebraska Center for Virology

EDUCATION: Ph.D., Oregon State University

START DATE: July 1, 2014



Animal Stress Physiologist

Dustin Yates

Assistant Professor
Animal Science

EDUCATION: Ph.D., New Mexico State University

START DATE: March 15, 2014



Functional Genomics

Jessica Petersen

Assistant Professor
Animal Science

EDUCATION: Ph.D., University of California-Davis

START DATE: January 1, 2014



Animal Breeding Genomics

Ron Lewis

Professor
Animal Science

EDUCATION: Ph.D., Virginia Polytechnic Institute
and State University

START DATE: January 6, 2014



Theoretical Quantitative Geneticist

Gota Morota

Assistant Professor
Animal Science

EDUCATION: Ph.D., University of Wisconsin-
Madison, expected May 2014

START DATE: August 1, 2014

Agroecosystems Ecologist

Julie Peterson

Assistant Professor
Entomology

EDUCATION: Ph.D., University of Kentucky

START DATE: March 3, 2014





Quantitative Ecologist

Sydney Everhart

Assistant Professor
Plant Pathology

EDUCATION: Ph.D., University of Georgia

START DATE: August 18, 2014

Computational Sciences

James Schnable

Assistant Professor
Agronomy & Horticulture

EDUCATION: Ph.D., University of California-Berkeley

START DATE: May 1, 2014





Computational Sciences

Tomáš Helikar

Assistant Professor
Biochemistry

EDUCATION: Ph.D., University of Nebraska Medical Center

START DATE: September 9, 2013

Behavioral Economics and Health Disparities

Christopher Gustafson

Assistant Professor
Agricultural Economics

EDUCATION: Ph.D., University of California-Davis

START DATE: September 1, 2013



Childhood Health Behaviors Extension Specialist

Dipti Dev

Assistant Professor
Child, Youth and Family Studies

EDUCATION: Ph.D., University of Illinois

START DATE: January 1, 2014



Food Safety Risk Assessment

Bing Wang

Assistant Professor
Food Science & Technology

EDUCATION: Ph.D., Iowa State University

START DATE: January 1, 2014





Food Lipid Chemistry & Functionality

Ozan Nazim Ciftci

Assistant Professor
Food Science & Technology

EDUCATION: Ph.D., University of Gaziantep, Turkey

START DATE: April 1, 2014



Lipid Metabolism & Health

Soonkyu Chung

Assistant Professor
Nutrition & Health Sciences

EDUCATION: Ph.D., University of North Carolina-
Greensboro

START DATE: January 1, 2014



Beef Systems Specialist

Mary Drewnoski

Assistant Professor
Animal Science

EDUCATION: Ph.D., North Carolina State University

START DATE: April 1, 2014

Forage/Crop Residue Specialist

Daren Redfearn

Associate Professor
Agronomy and Horticulture

EDUCATION: Ph.D., University of Nebraska-Lincoln

START DATE: June 16, 2014



Other Hires – since January 1, 2012

- **Water cluster (5)**

- *Crop simulation modeler*
- *Irrigation engineer*
- *Hydroinformaticist*
- *Hydrogeophysicist*
- *Cropping systems Agronomist*

- **Ag Economics cluster (3)**

- *Marketing and risk management economist*
- *Grain, oilseed, and biofuel economist*
- *Livestock economist*

- **Additional hires (17)**

- *17 positions in 10 departments*

Hires – since January 1, 2012

- **Priority Positions – 38 positions (including 7 in process)**
- **Water Cluster – 5 positions**
- **Ag Economics Cluster – 3 positions**
- **Additional Hires – 17 positions**

- **63 new hires – total faculty (tenure track/tenured) in IANR now 346**
 - **22%**

- **There are also 255 non-tenure track faculty members in IANR**



Phase I = 38 + 5 + 3



Phase II = 20?



 **GROWING A HEALTHY FUTURE**

FOOD • FUEL • WATER • LANDSCAPES • PEOPLE

IANR to 2025

Facilities and Infrastructure



Teaching, Research, and Extension

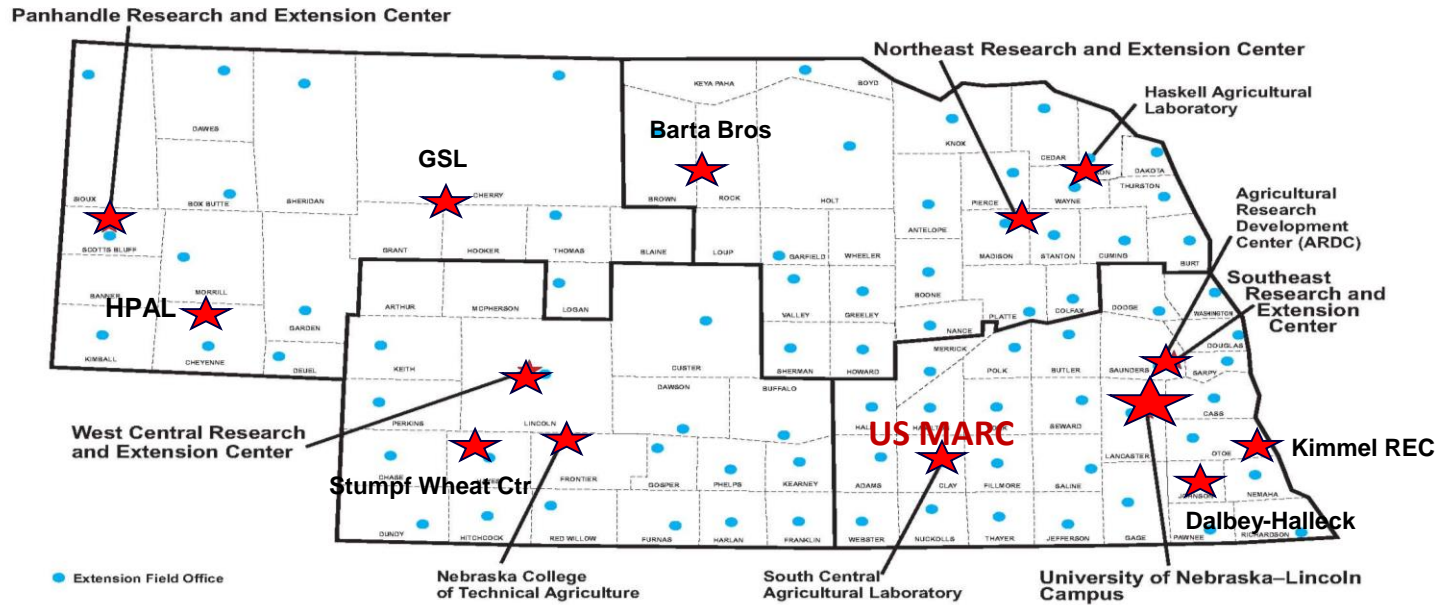

IANR = 38,950 acres

NU = 43,734 acres





1,957

**people passionate about
making a difference**

- **1,094** IANR employees work on campus
- **863** IANR employees are located in Nebraska communities statewide
- **635** total faculty (7 in recruitment)

East Campus Master Plan



... The map to follow for any project

East Campus Recreation Center



**Open Late
Summer 2015**



Veterinary Diagnostic Center



Opening in 2017



Biofibers Research Lab



Opened in Fall 2013

Commodity Trading Room

Dept. of Ag. Economics, Filley Hall 57



Opening in Spring 2014

Classroom Enhancements



Chase 116



Ruth Leverton 304

**Upgrades for Filley 115 & 210,
Plant Science 199**

Consortium for Integrated Translational Biology
Creating a transdisciplinary environment to bridge the
genotype to phenotype gap

Plant Genetic Variation

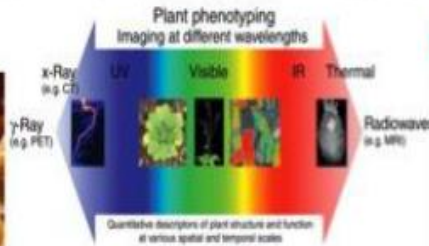

Capturing Phenotype



**Lab to Field
Infrastructure**

Additional Campus Projects

- Ag Communications – office upgrades
- ANSC feed storage bldg – in progress
- ANSC hoop structure from ARDC
- Beadle/Bioinformatics – in progress

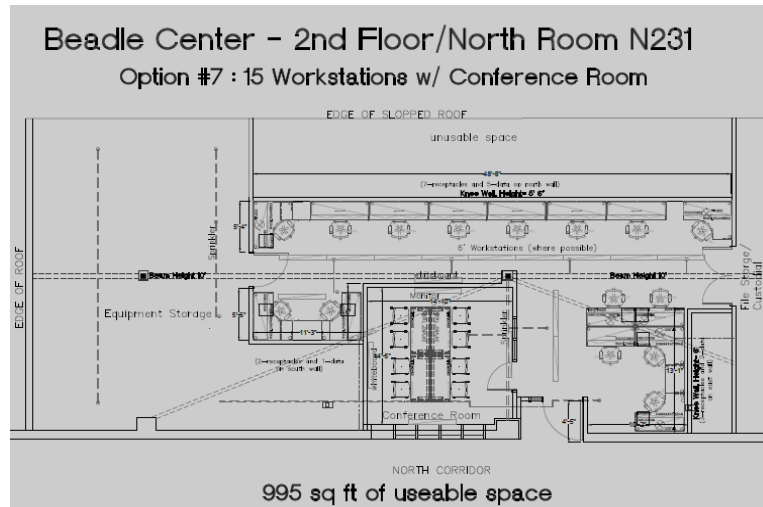



Proposed South “Gates” to East Campus

“Legacy” Plaza



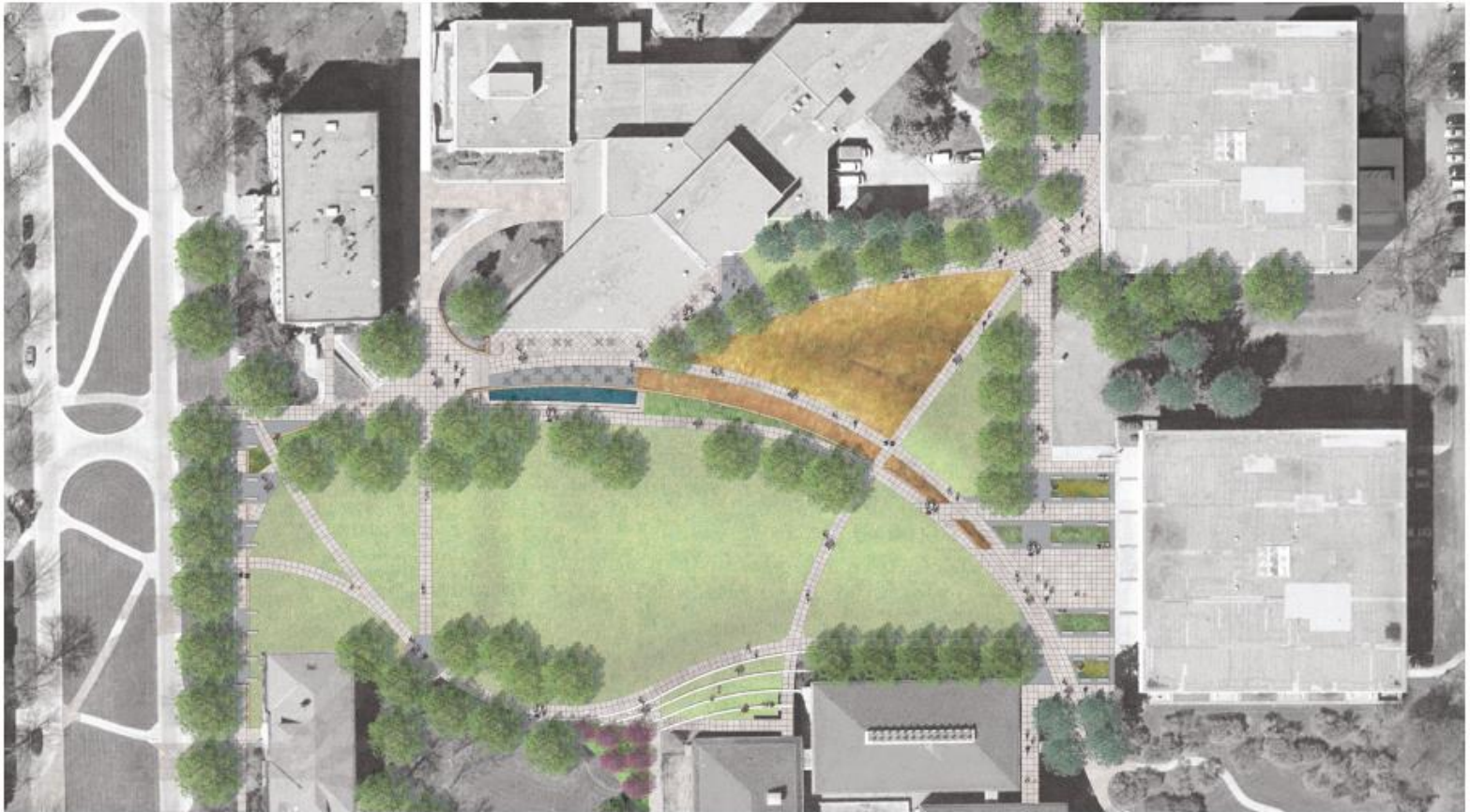

Site Plan



LEGACY PLAZA
UNL EAST CAMPUS



C.Y. Thompson Student Learning Commons

EXTERIOR | veranda

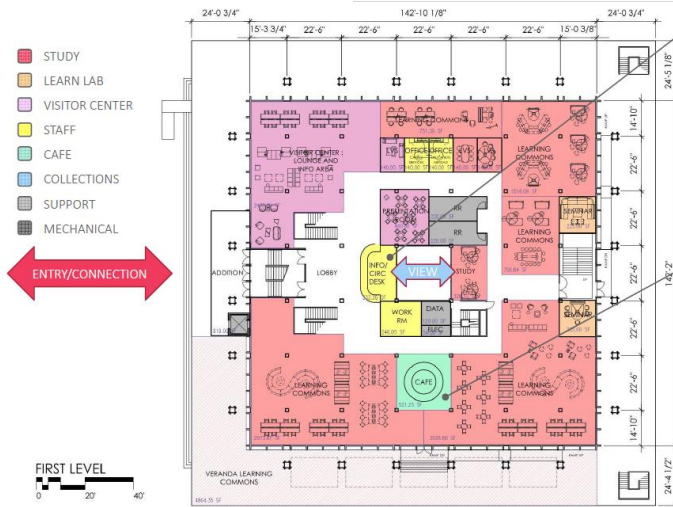

FLOOR PLANS | scheme (1)



Burr/Fedde Residence Halls



Ongoing Discussions

Biochemistry/Miller Hall



Potential Spaces for
new Housing



Holdrege St – AΓP House



Holdrege Street – 35 West



Opening March 1



NEBRASKA
INNOVATION
CAMPUS



Innovation Campus

Phase 1 Building – 350,000 sq. feet



UNL Dept. of Food Science and Technology!!



NEBRASKA
INNOVATION
CAMPUS



NEBRASKA
INNOVATION
CAMPUS



Havelock Farm – Popcorn Research



Planned Completion – Summer 2014

Stumpf International Wheat Center

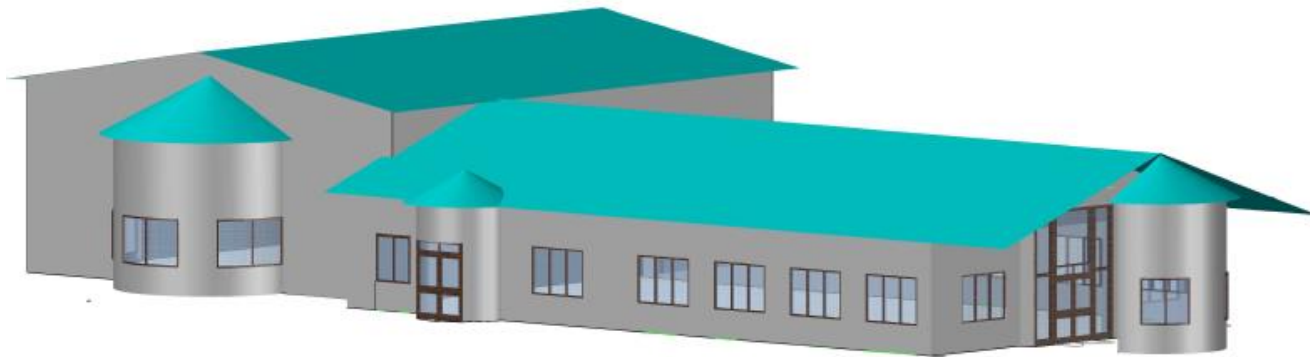

Selecting Design Firm
Opening Late 2014

WCREC – New Entomology Bldg



Completion – spring 2014

WCREC – Snyder Addition



Scheduled to be completed by April 2014

PHREC Elliott Building Upgrade



HPAL – New Hdqrs Bldg at Sidney



Scheduled to be completed by May 2014

Animal Handling Facility Panhandle REC



Off Campus Projects (309 Funds)

- **Machine Storage at Brule – Done**
- **Waste Management Facility at ARDC - Done**
- **Pedestrian Bridges at Haskell – Done**
- **New roofs at Gudmundsen & West Central REC – Done**



State Fair “Ag Literacy” Learning Center





Servant Leaders

Panhandle REC



Gary Hergert



Jim Schild

Northeast REC



Twig Marston



Bill Kranz



Denny Bauer

School of Veterinary Medicine and Biomedical Sciences



David Hardin



Don Beermann

UNL Extension



Wayne Moore
Associate Director

rural futures



Mark Gustafson



Chuck Schroeder



Servant Leaders



Daniel Cady

Director

NE Local Technical
Assistance Program

17 Years of Service



Servant Leaders



Betty Castan
Associate Video Media
Ed Media
44 Years of Service



Servant Leaders



Tom Dorn
Extension Educator
Southeast REC
33 Years of Service



Servant Leaders

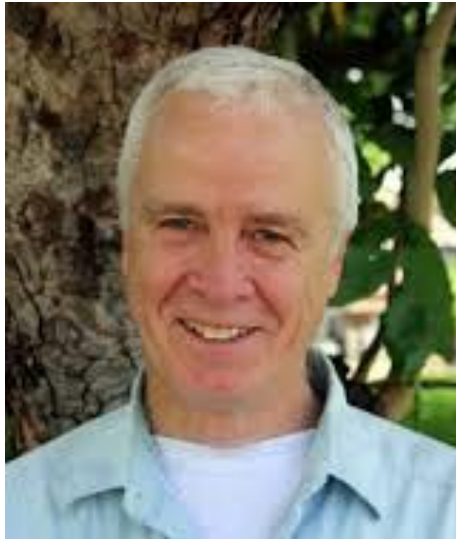

Marion Ellis
Professor
Entomology
18 Years of Service



Servant Leaders



John Foster
Professor
Entomology
19 Years of Service



Servant Leaders



Roy French
Adjunct Professor
Plant Pathology
26 Years of Service



Servant Leaders



Mark Gustafson

Director

Rural Futures

Institute

7 Years of Service



Servant Leaders



Jan Harris
Staff Assistant
Child, Youth, and
Family Studies
25 Years of Service



Servant Leaders



Ronald Harris
Ag Research Technician
USMARC
32 Years of Service



Servant Leaders



Mary Ann Holland
Extension Educator
Southeast REC
42 Years of Service



Servant Leaders



Judy Huff
Office Associate
Animal Science
29 Years of Service



Servant Leaders



Bruce Johnson
Professor
Agricultural Economics
38 Years of Service



Servant Leaders



Eileen Jepsen
Food Service Associate
NCTA
24 Years of Service



Servant Leaders



Lilo “Lee” Johnson
Office Associate
SVMBS
28 Years of Service



Servant Leaders



Nelvie Lienemann
Administrative Support
Associate
ARD
27 Years of Service



Servant Leaders



Abe Lineberry
Motor Transport
Operator
NE Forest Service
3 Years of Service



Servant Leaders



Sandy Lineberry
Office Associate
NE Forest Service
32 Years of Service



Servant Leaders



Alan Moeller
Assistant Vice
Chancellor
IANR

36 Years of Service



Servant Leaders

Connie Paxton
Business Associate
Natural Resources
Business Center
18 Years of Service



Servant Leaders



Duane Reese
Professor
Animal Science
29 Years of Service



Servant Leaders



Jack Schinstock
Associate Dean &
Professor
Biological Systems Eng.
36 Years of Service



Servant Leaders



Bonita Schuster
Office Assistant
Agricultural Economics
29 Years of Service



Servant Leaders



Mary Spalding
Professor
School of Natural
Resources
39 Years of Service



Servant Leaders

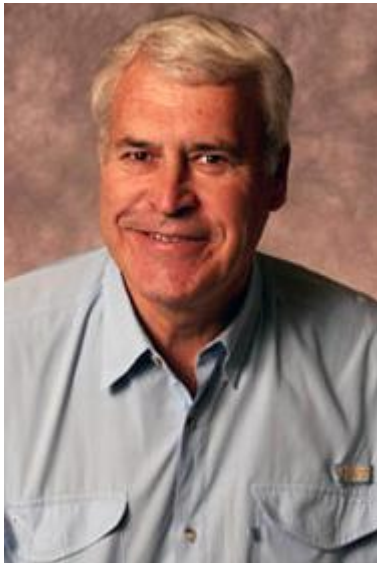

Roy Spalding
Professor
Agronomy &
Horticulture
39 Years of Service



Servant Leaders



Cindy Strasheim
Extension Educator
Southeast REC
30 Years of Service



Servant Leaders



Gary Varvel
USDA-ARS
Agronomy &
Horticulture
30 Years of Service



Servant Leaders



Ken Vogel
USDA-ARS
Agronomy &
Horticulture
39 Years of Service

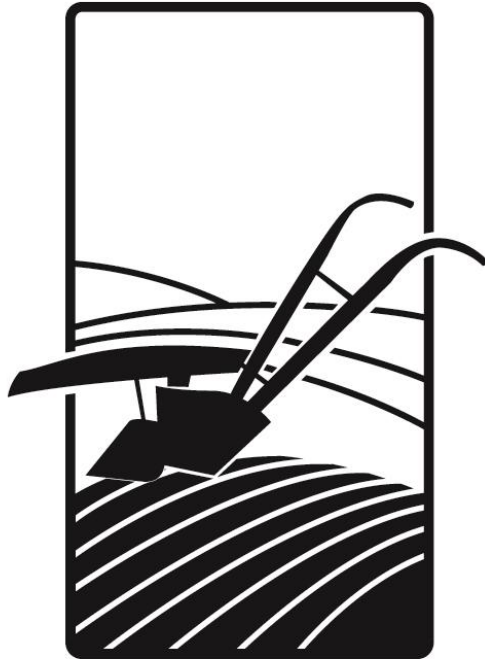

Servant Leaders





2013

WORKING TO MEET THE WORLD'S GROWING FOOD NEEDS
HEUERMANN LECTURES

2014



WORKING TO MEET THE WORLD'S GROWING FOOD NEEDS
HEUERMANN LECTURES

Streamed live at heuermannlectures.unl.edu

**OUR CULTURE WAR
OVER FOOD AND FARMING**

DR. ROBERT PAARLBERG

BETTY FREYHOF JOHNSON '44 PROFESSOR,
DEPARTMENT OF POLITICAL SCIENCE, WELLESLEY COLLEGE;
AUTHOR OF "FOOD POLITICS: WHAT EVERYONE NEEDS TO KNOW"

3:30 P.M. THURSDAY, FEB. 27
3:00 P.M. RECEPTION



LOCATION:
HARDIN HALL, 33RD AND
HOLDREGE, LINCOLN, NE

 @HeuermannSeries

 facebook.com/HeuermannLectures

ANYONE WHO REQUIRES REASONABLE ACCOMMODATIONS UNDER THE AMERICANS WITH DISABILITIES ACT, PLEASE CONTACT JUDY NELSON AT 402-472-3031, OR jnelsonsh@unl.edu, TWO WEEKS PRIOR TO THE EVENT.

THE UNIVERSITY OF NEBRASKA-LINCOLN IS AN EQUAL OPPORTUNITY EDUCATOR AND EMPLOYER.



UNIVERSITY OF
Nebraska
Lincoln



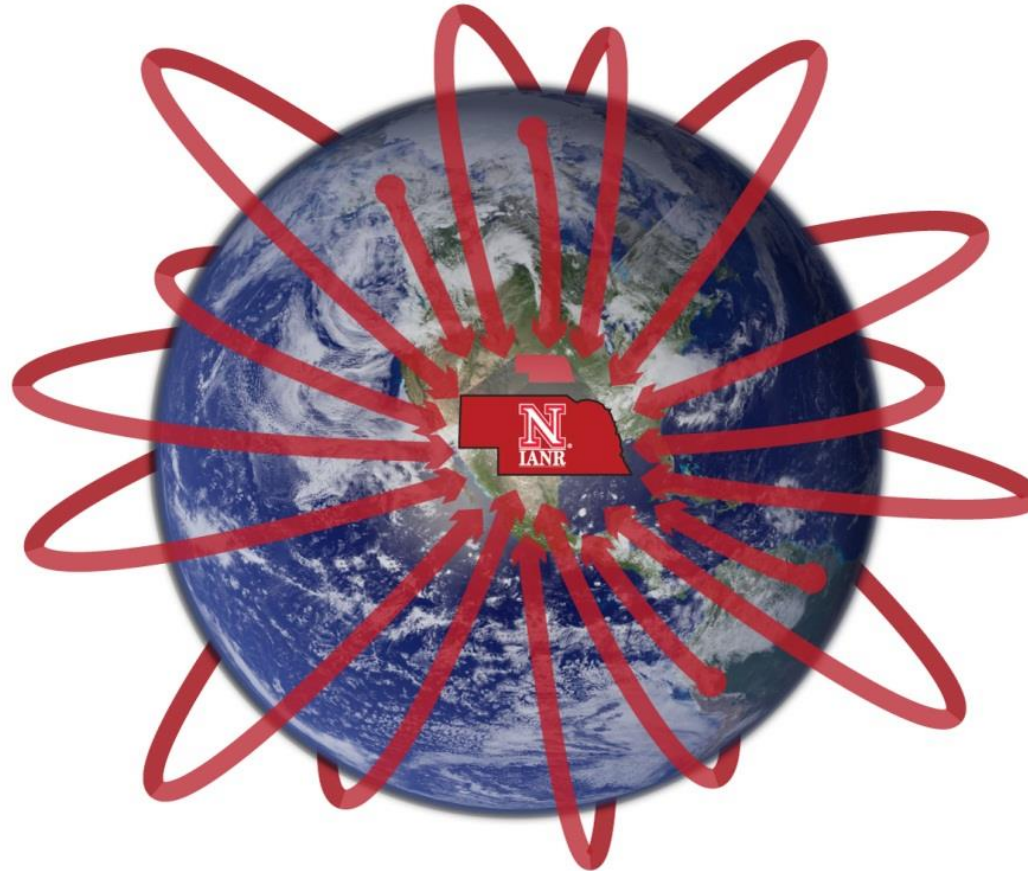

GROWING A HEALTHY FUTURE

FOOD • FUEL • WATER • LANDSCAPES • PEOPLE